

Planning a Cremation Burial



CATHOLIC CEMETERIES ASSOCIATION
DIOCESE OF CLEVELAND
Faith, Hope, and Remembrance

Contact Information

All Saints Cemetery
480 W. Highland Road
Northfield, OH 44067
(216) 641-7575 Ext. 5



*We appreciate the opportunity to be of service to your family.
Our heartfelt condolences to you at this time of loss.*

Your Family Service Representatives



Joe Kun
(216) 883-5478



Kelly Meehan
(440) 499-7517



Scheduling a Cremation Burial

- ✚ Select the burial date and contact All Saints Cemetery office at (216) 641-7575 x 5.
- ✚ Discuss burial plans with a Family Service Representative.
- ✚ Set an appointment to select a new burial location or to confirm existing burial arrangements.
- ✚ Complete the burial contract. The cemetery will need a completed contract and signature in order to authorize a burial.
- ✚ Provide the cremation certificate to your Family Service Representative.

Scheduling a Cremation Burial

- ✚ All Saints Cemetery will need at least 48 hours notice in order to accommodate a burial request. Burials may take place Monday-Saturday 9:00 a.m.-2:30 p.m. (excluding certain holidays)
- ✚ Burials that are scheduled late in the afternoon, from 3:00-5:00 p.m. will incur an additional charge.
- ✚ If you would like a priest or deacon at the service, each family will arrange this with the church. It is best to have this confirmed with the church before selecting the burial date/time.
- ✚ When scheduling the burial with your Family Service Representative, a Gathering Place will be assigned for you and your family to meet on the burial day. Please share this information with family and friends who plan to attend the burial at the cemetery.



Cremation Gathering Locations for Interment

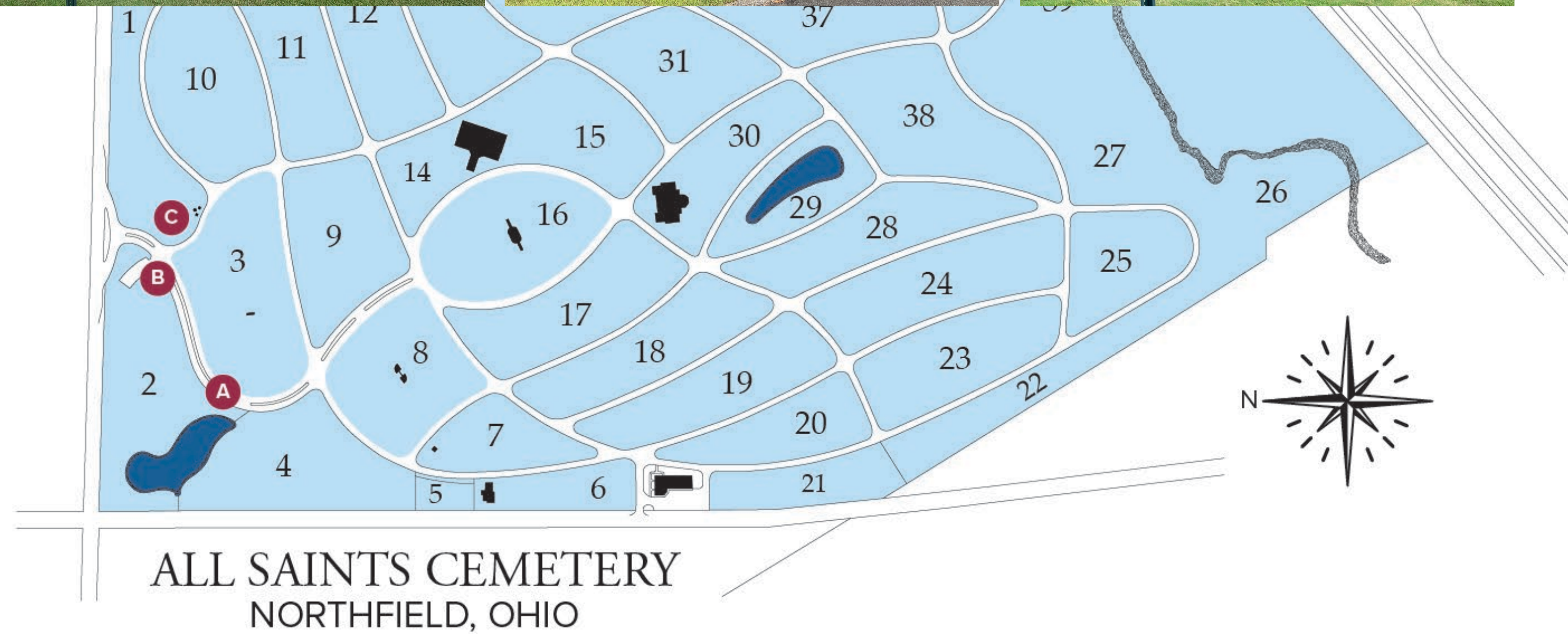

Scheduling a Cremation Burial

- ✝ Burial containers - Family Service Representatives will need to confirm the container information when scheduling the burial.
- ✝ In ground burials - remains must be in a CCA approved cultured marble urn or be placed inside a cremation burial vault.
- ✝ Above ground burials - burial container dimensions should be available in order to ensure the container will fit inside the niche.
- ✝ Double niches - will need to consider both burial container sizes.





Scheduling a Cremation Burial

- ✚ A wooden pedestal will be setup at the burial location, The urn or burial container may be placed on the pedestal for the service.
- ✚ If you would like to be present for the burial, please discuss this with your Family Service Representative as you are planning the burial and finalizing burial details.

The Day of Burial

- † Family and friends should arrive at the cemetery gathering location at least 10 minutes prior to the scheduled burial time.
 - † The escort will collect the cremation certificate before you proceed to the burial location. (Unless the certificate was previously provided when scheduling the burial).
 - † Cremation Certificates: Please note we will NOT be able to complete a burial if a cremation certificate has not been received.
 - † Gravesite services are typically 15-20 minutes long.
- † Once the service is complete, the family is asked to wave over the field staff so that they may complete the burial.
 - † Once the staff approaches the burial location, guests may proceed to their vehicles.
 - † Remains should never be left unattended.
 - † If you would like to be present for the burial, and did not previously arrange this with the FSR, please waive the field staff to the burial location and let them know that you would like to be present until the burial has been completed.